

- NOTE(S):
 1. APPLY NSF COMPLIANT GREASE TO ANY O-RING, SEALING JOINTS, AND/OR PIVOTAL POINTS.
 2. APPLY NSF COMPLIANT LOCTITE TO THREADED AREA. 

ITEM NO.	PART NUMBER	DESCRIPTION	QTY.
1	10986	CENTERING PLATE SLEEVE	1
2	3-1428/00	CROSS HANDLE, WALL/SHOWER, 500 SERIES	1
2.1	10538/00	CAP RING FOR 500 SERIES BUTTON	1
2.2	10622/00	HUB FOR HANDLE, CROSS	1
2.3	10623/00	HANDLE FINIAL CROSS	4
2.4	92008	SET SCREW, CUP POINT 8-32	2
2.5	10621/00	BASE HUB NUT	1
2.6	10618/00	ESCUTCHEON, TRADITIONAL 500	1
2.7	11097	PLASTIC BUTTON, BLANK	1
3	92184	HEX L-KEY 3/32" HEX x 2 1/8"L	1
4	P17009/00	PRESSURE BALANCE TRIM PLATE	1

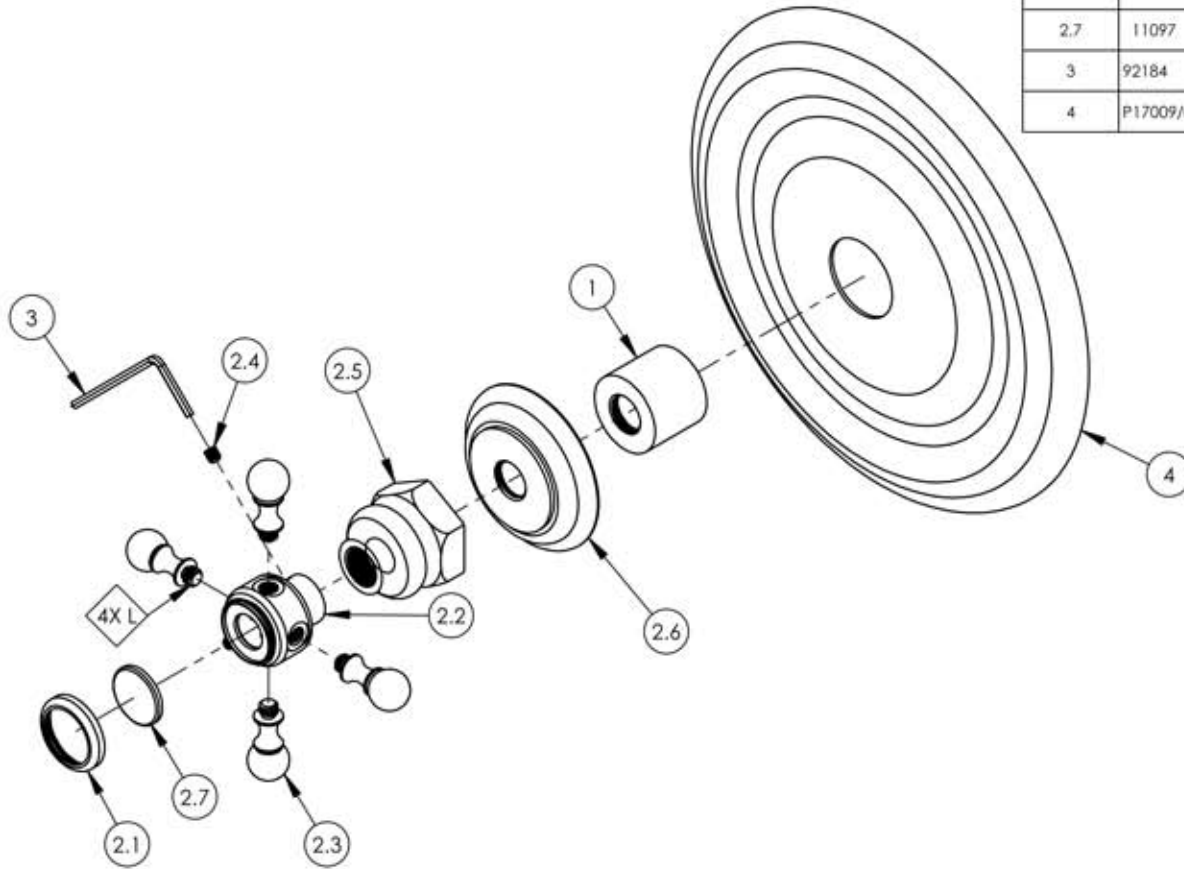

ZONE	REV.	DESCRIPTION	DATE	APPROVED
------	------	-------------	------	----------

REVISIONS

1261 LOGAN AVENUE COSTA MESA, CALIFORNIA 92626 PHONE: 714.361.4800 FAX: 714.617.3120	<h1>PHYLORICH®</h1> <p>Defining Luxury Since 1959</p>	PROPRIETARY AND CONFIDENTIAL THE INFORMATION CONTAINED IN THIS DRAWING IS THE SOLE PROPERTY OF RSS MANUFACTURING. ANY REPRODUCTION IN PART OR AS A WHOLE WITHOUT THE WRITTEN PERMISSION OF RSS MANUFACTURING IS PROHIBITED.

-	-	INTERPRET GEOMETRIC DIMENSIONING & TOLERANCING IN ACCORDANCE WITH ASME Y14.5-2009 & ASME Y14.41-2003 STANDARDS, UNLESS OTHERWISE SPECIFIED. DIMENSIONS ARE IN INCHES. TOLERANCES ARE:		
NEXT ASSY	USED ON	FRACTIONS ±1/64"	DECIMALS X.X: ±.1 X.XX: ±.01 X.XXX: ±.005	ANGULAR ±.5°
APPLICATION		MATERIAL	NAME	DATE
FINISH		DRAWN	LLO	10/26/2015
DO NOT SCALE DRAWING		CHECKED	GRE	

1/2" MINI THERMOSTATIC SHOWER TRIM, CROSS HANDLES

SIZE	ASM/PRT NO.	REV
A	4-097/00	-
SCALE: 1:2.5	WEIGHT: lbs.	SHEET 1 OF 2